

ARCHAEOLOGICAL MUSEUM OF ERETRIA

EUBOEA



The Eretria Museum houses finds from the city, temples and cemeteries of Eretria, and also from Amarynthos and Lefkandi dating from the Neolithic period (5500-2800 BC) down to Roman times (146-86 BC). The exhibits are representative of the history, the acme and decline of the ancient city.

The history of the city begins in the Neolithic period (5500-2800 BC). The city and the acropolis preserve considerable remains of the Early (2800-1900 BC) and Middle (1900-1650 BC) Bronze Age, and also of the Mycenaean period (1650-1100 BC). The Geometric period (9th and 8th c. BC) was highly important. At this time, Eretria, along with Chalkis, took part in the Euboean colonisation movement in the East and West. In the 8th c. BC, the city clashed with Chalkis for possession of the Lelantine plain, and evolved into an organised city. In the 6th c. BC, the temple of Apollo Daphnephoros was built on the remains of earlier temples, and was destroyed by the Persians in 490 BC. In the 5th c. BC Athenian cleruchs were established and the city came under Athenian influence. In 338 BC it received a Macedonian garrison and remained under Macedonian sovereignty until the Roman conquest in 146 BC. In 86 BC it was comprehensively destroyed by the Romans and gradually abandoned.

ROOM I

Cases 1-5 contain exhibits from the prehistoric settlement at Xiropolis (2100-1100 BC) and from the Protogeometric cemeteries at Lefkandi (11th-9th c. BC). In **case 6** are displayed finds from prehistoric Amarynthos, and **case 7** also has prehistoric finds, from Magoula and Eretria. **Cases 8-11** contain items from the Geometric period (900-700 BC) from Eretria. In **case 9** is displayed a funerary amphora. **Cases 10 and 11** include grave offerings from the tombs of the Heroon found in the north-west section of the city: bronze cauldrons that contained burnt bones, a gold diadem and jewellery.

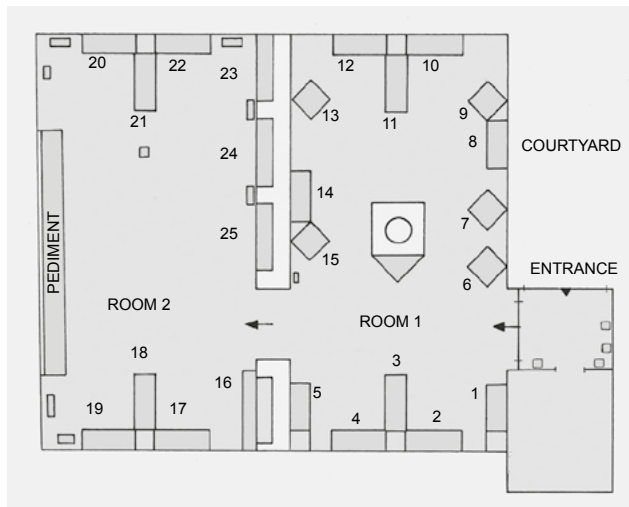

In **case 10** there are Corinthian aryballoi, serpentine scarabs, and the swords of the deceased. **Case 12** contains dedications from the temple of Apollo Daphnephoros (8th and 7th c. BC), local and imported pottery, bronze vessels and figurines from the East, scarabs and sealstones. In **case 13** is exhibited a 7th c. BC funerary amphora; **case 14** contains finds from the Archaic cemeteries of Eretria (mainly black-figure pottery); and **case 15** has a 6th c. BC funerary amphora with a depiction of Herakles and a Centaur.



ROOM 2

This room is dominated by the west pediment of the temple of Apollo Daphnephoros (520 BC), depicting the abduction of Antiope, queen of the Amazons, by Theseus, a masterpiece of late Archaic art. Various vessels of everyday use (lamps, fish-hooks, blades) and coins are displayed in **case 16**. **Case 17** includes objects that adorned houses from the 4th c. BC onwards. Also of interest is the clay gorgoneion from the House of the Mosaics, which was discovered in the centre of the city. Panathenaic amphoras (awarded as prizes to victors in the games), found in Eretria, are displayed in **case 18**, and **case 19** contains objects connected with cult. **Cases 20-21** are devoted to objects from the Classical and Hellenistic cemeteries at Eretria. In **case 22** are exhibited remains of the Macedonian Tomb known as the "Tomb of the Erotes", to the north-west of the city, and **case 23** contains objects from Eretria, mainly of local production.



Case 24 also contains finds of the 4th and 3rd c. BC from Eretria. Finally, **case 25** has a display of objects from a storage pit in the sanctuary of Artemis Amarynthia. The black-figure epinetron is of interest. Sculptures of various periods are also on display in this room. The 4th c. BC stele with Apollo Mousagetes and Artemis is of particular interest.

COURTYARD

Funerary monuments, inscriptions and architectural members, a pottery kiln and mosaics are on display in the Museum's courtyard.





ARCHAEOLOGICAL
MUSEUM OF ERETRIA

EUBOEA



i T: 22290 62206

TEXT: E. SAPOUNA SAKELLARAKI

GENERAL SUPERVISION: ARF, PUBLICATIONS DEPARTMENT

LAYOUT: MOUNTZOURI ATHINA



ΜΝΗΜΕΙΑ ΚΑΙ ΜΟΥΣΕΙΑ ΤΗΣ ΕΛΛΑΔΑΣ
MONUMENTS AND MUSEUMS OF GREECE
e-Ticketing system



HELLENIC REPUBLIC
Ministry of Culture and Sports



Archaeological Resources Fund
www.tap.gr